

PMH-3080

POLYMER SELF-ADHERING MEMBRANE WATERPROOFING SHEET

MATERIAL

Structural Display

Anti-adhesive and
weather-resistant granular layer

Polymer self-adhering layer

Synthetic polymer
base-membrane

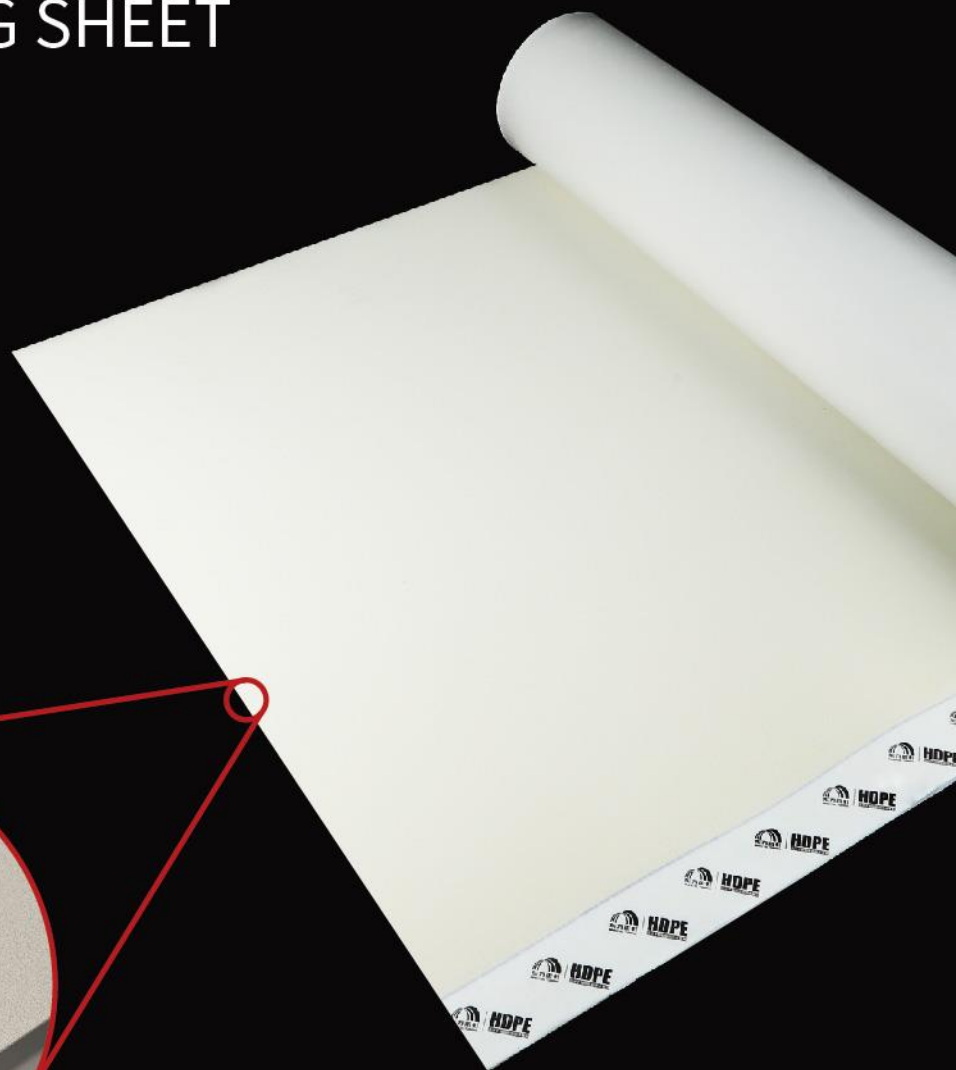
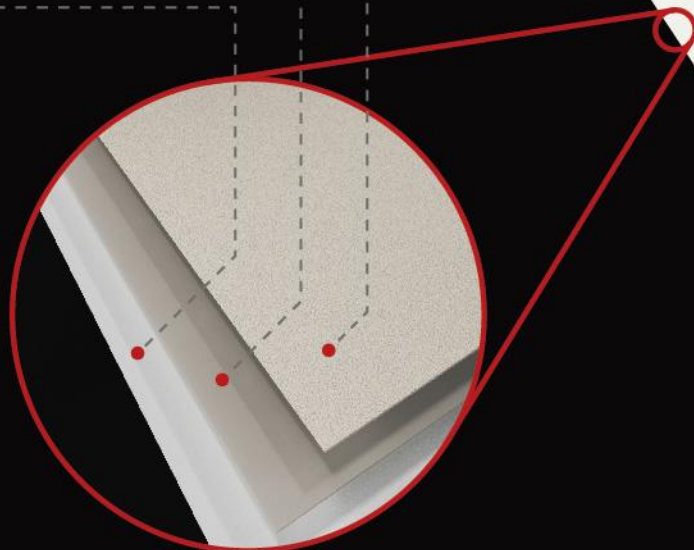

The base-membrane of PMH-3080 polymer Self-adhering Membrane Waterproofing Sheet is made of HDPE sheets whose one side covered with non-asphalt-based polymer self-adhering layer. The surface of the adhesive layer is covered with anti-sticking and weather-resistant granular layer. With in the long-side of the coiled material, a 80mm wide adhesive overlapping band or 100mm wide welding overlapping band is reserved, which can be used for pre-applied anti-sticking construction waterproof sheet.

PMH

30
80

PACKING AND SPECIFICATION

External Packing



Width of sheet (m)

1.2, 2.4

Thickness of sheet (mm)

1.2, 1.5, 1.7

Length of sheet (m)

20

Area (m²/roll)

24, 48

Note:

The standard thickness of the product are 1.2mm, 1.5mm or 1.7mm.

Other specifications can be customized according to project requirements.



TYPICAL PHYSICAL PROPERTIES

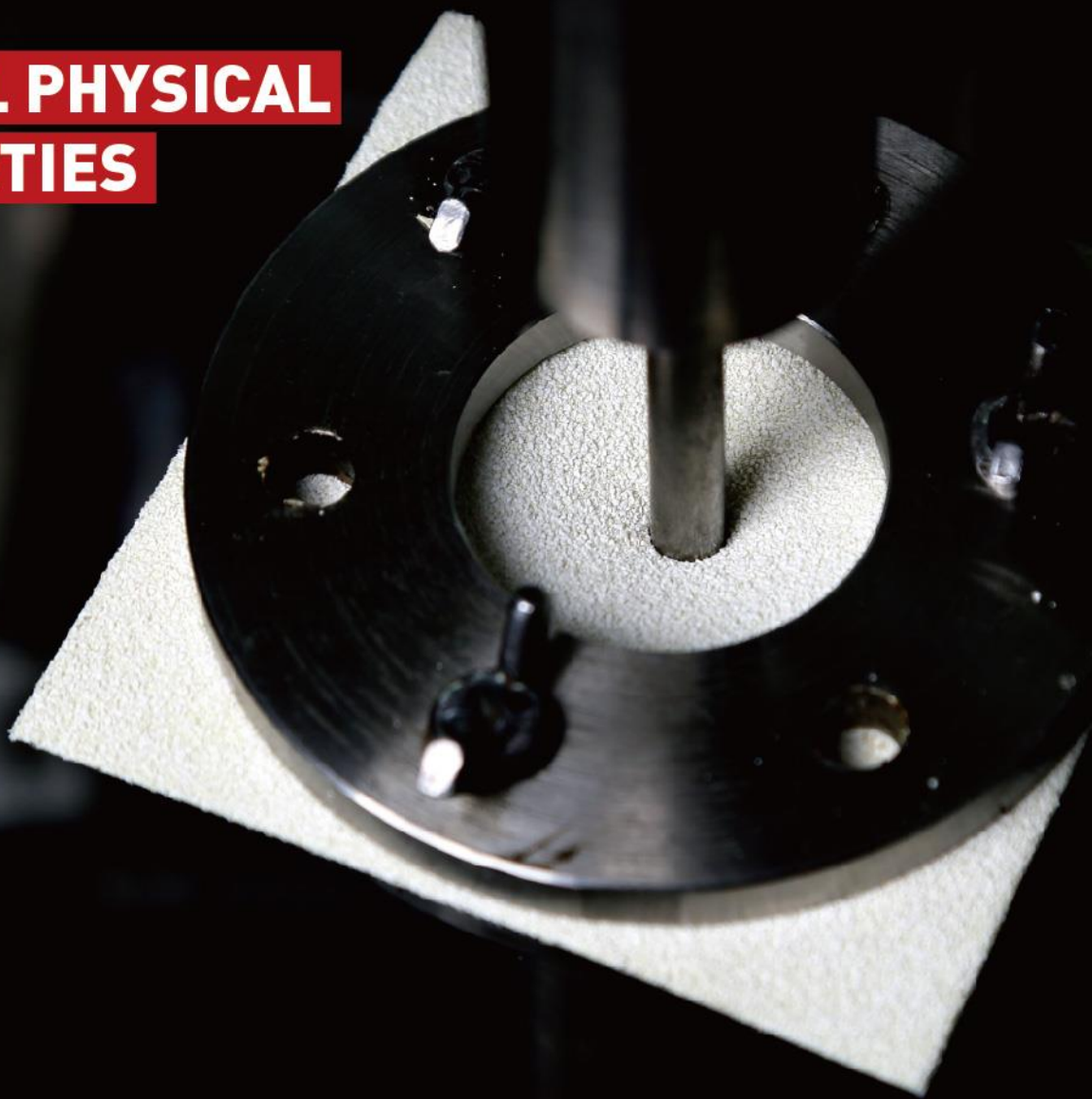

Test Item

Thickness, mm

Tensile strength, MPa ASTM D412

Elongation,% ASTM D412

Puncture resistance,N ASTM E154

Bond strength to concrete, N/m ASTM D903

Peel strength at lapping, N/m ASTM D1876

Standard Index

1.15~1.25

≥25

≥400

>700

≥880

≥880

The product implements the P-class pre-applied requirements of GB-23457-2017
"Pre-applied waterproofing sheets".

SCOPE OF APPLICATION

01

Structural floor of the civil and industrial basement, structural flank-wall applied by external-protection & internal-stick method and comprehensive underground space.

02

Road tunnels, railway tunnels, water delivery tunnels and rock caverns project excavated by mine tunnelling method.

03

Structural bottom plate of urban utility tunnel, structural flank-wall applied by external-protection & internal-stick method.

04

Open-digging subway station structural floor, structural flank-wall applied by external-protection & internal-stick method, subway station applied by underground excavation and subway tunnel constructed by shallow buried underground excavation.



OVERLAPPING METHOD

PMH-3080 Polymer Self-adhering Membrane Waterproofing Sheet

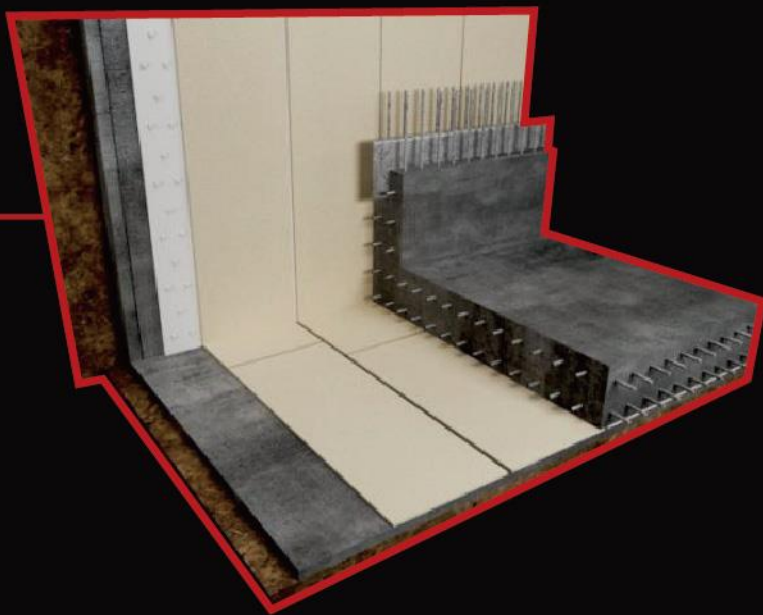

01

PMH-3080 Long-edge bonding

During the bonding operation, on the premise of ensuring that the bonding interface is clean, a professional pressure plate should be used to strictly press the exhaust.



02

PMH-3080 Long-edge welding

During the welding operation, test welding should be performed in advance to determine the working parameters of the crawler welding machine.

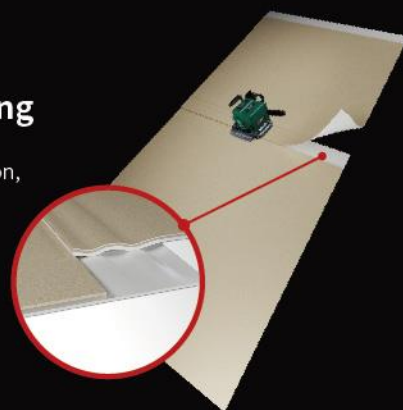

03

PMH-3080 Short-edge bonding

Overlapping bonding with pressure, the auxiliary materials of the manufacturer should be selected.



04

PMH-3080 Short-edge welding

Tailor-welding.

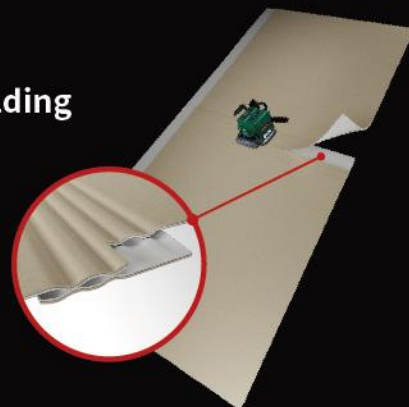

ADVANTAGES



Excellent mechanical properties:

High tensile strength, high elongation, impact resistance, good puncture resistance.



Bonding Strong:

Form a permanent gapless bonding with the post-poured concrete layer to prevent water spraying.



Various types of overlapping:

Various types of overlapping for both long and short sides, bonding and welding are available.



Green and environmental protection:

Environmentally friendly, contains no harmful chemicals and does not require the usage of solvent-based primers during construction.



Good construction performance:

The construction is convenient, just empty paving with concrete layer, dustproof design, resistant to stepping, personnel can normally carry out follow-up work above it.



High cost performance:

Only with a single layer paving, the material can meet the requirements of Grade 1 waterproofing design. After laying, no protective layer is needed to be construction, directly tie the rebars, pour structural concrete is OK. And the material are full bonded with structure of the baseboard, A truly composite waterproofing system is realized. It maximum extent possible to avoid the appearance of infiltration and water spraying. Compared with the traditional waterproofing system to reduce maintenance and repair costs, showing long-term economic performance.

TECHNICAL NOTES

01

When the ambient temperature is between $-5 \sim 10^{\circ}\text{C}$, it should be replaced by low-temperature version of the coiled material and auxiliary materials.

02

Waterproofing sheet construction should ensure that the whole concrete layer have no visible water. If fails to guarantee, it will lead to self-adhering part failure, there exists a risk of leakage in later period. It is advisable to consult HDPE Product Development in advance to confirm the replacement with special grade material and auxiliary materials that are suitable for underwater bonding.

03

It is recommended to build brick mould around the base plate. If a detachable template is selected, the mould removal time should be no less than 7 days and avoid mechanical disturbance. After removing the mold, apply the closing bead and sealant, and fill it in time.

04

The upward overlapping method of the coiled material and the heterogeneous material is finally determined according to the actual situation on site.

*For more detailed technical notes,
consult the HDPE Technology Development Department



东方雨虹 ORIENTAL YUHONG

Scan our QR Code and follow the
official Wechat of Oriental Yuhong

400-779-1975

www.yuhong.com.cn

CE 0038/13

东方雨虹
ORIENTAL YUHONG

PMH-3080